



NORTEC aurum

Raised floor with highest demands to sustainability

The NORTEC aurum floor panels are made from calcium sulphate and are classified as non-combustible. We have a direct influence on the selection of raw materials for our in-house production facility: the use of pre- and post-consumer waste paper means for instance that almost all NORTEC panels are FSC® certified. The Institut für Baubiologie in Rosenheim (IBR, Institute for Biologically Sound Construction) also recommends NORTEC as harmless in terms of building biology. Its convincing ecological and technical properties enable the system to be processed "from the cradle to the cradle". As the world's first system floor, NORTEC aurum is Cradle to Cradle Certified® Gold. This flooring system can even be manufactured as carbon-neutral on request. The diverse combination options between NORTEC aurum and other systems ensure a high degree of versatility.

- fibre-reinforced calcium sulphate panel without edge trim
- superb walking comfort
- high loadability
- non-combustible
- easy lifting and exchanging of single panels

Samples for building portfolio

Common Rooms, Office Buildings, Broadcasting and Television Production Studios, Library Rooms, Higher Education Institutions, Schools, Clinics and Hospitals, Banks, Shopping Centres, Sales Areas, Places of Assembly, Train Stations, Airports, Underground Railways/Tunnels, Power Plants, Laboratories and Research, Production Facilities, Court and Government Buildings, Entrance Areas, Necessary Corridors

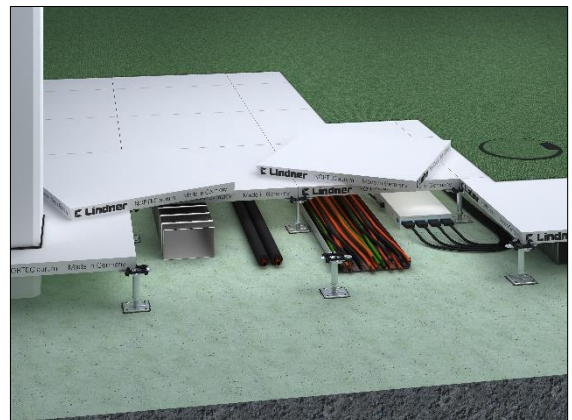

Technical data

Weight	34 - 70 kg/m ²
Panel thickness	30 - 38.5 mm
Standard pedestal height	20 - 2,000 mm
Pedestal grid	600 mm x 600 mm
Dimensional deviation	class 1

Statics

Load and deflection class	DIN EN 12825	1A - 5A
Point load (breaking load)	DIN EN 12825	2 kN (4 kN) - 5 kN (10 kN)
Seismic safety		earthquake-proof construction possible



Fire protection

Building material class of the carrier panel

Building material class	DIN EN 13501-1	A1
Building material class	DIN 4102-1	A2
Designation by the building authorities	DIN EN 13501-1	non-combustible
Designation by the building authorities	DIN 4102-1	non-combustible

Fire resistance

Fire resistance	DIN EN 4102-2	F 30 possible with additional measures
Fire resistance	DIN EN 13501-2	REI 30 possible with additional measures

Acoustics

Building acoustics

Normalised flanking level difference depending on additional measures	DIN EN ISO 10848	$D_{n,f,w}$	47 - 64 dB
Rated sound reduction index depending on additional measures	DIN EN ISO 10140-2	R_w	61 dB
Reduction of impact sound pressure level depending on additional measures	DIN EN ISO 10140-1	ΔL_w	11 - 36 dB
Normalised flanking impact sound pressure level depending on additional measures	DIN EN ISO 10848-2	$L_{n,f,w}$	73 - 38 dB

Sustainability

Circular economy	Cradle to Cradle Certified® Gold
Self-declaration	self-declaration in acc. with ISO 14021 possible
Environmental product declaration	verified EPD in acc. with EN 15804 / ISO 14025 possible
FSC	optional (TUEV-COC-000515)
French VOC Regulation	Emission class A+

Floor coverings

Suitability of covering	loose-laid coverings
-------------------------	----------------------