

Biocenter

Copenhagen, Denmark





Project Description

Lindner fitted glazed partition walls and metal ceilings to this project.

General

Building Type	Schools
Company Division	Lindner SE International Projects Contracting
Completion	2005 - 2006
Client	Universität Kopenhagen
Architect	KHR Arkitekter A/S

Completed Works

- **Partitions**

Partition Systems Glass

Wall and ceiling panels

Doors for Partition Systems

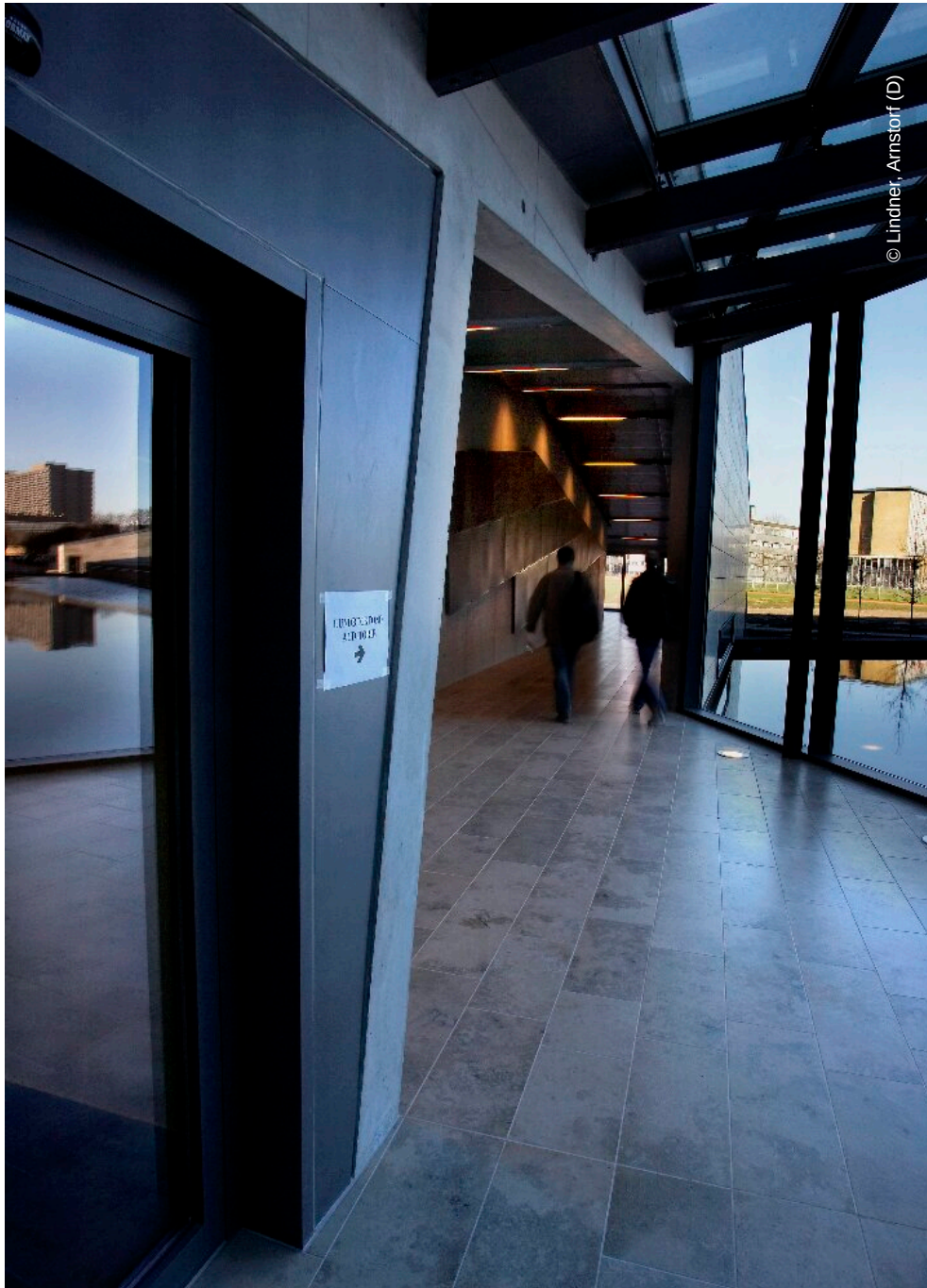

© Lindner, Arnstorf (D)

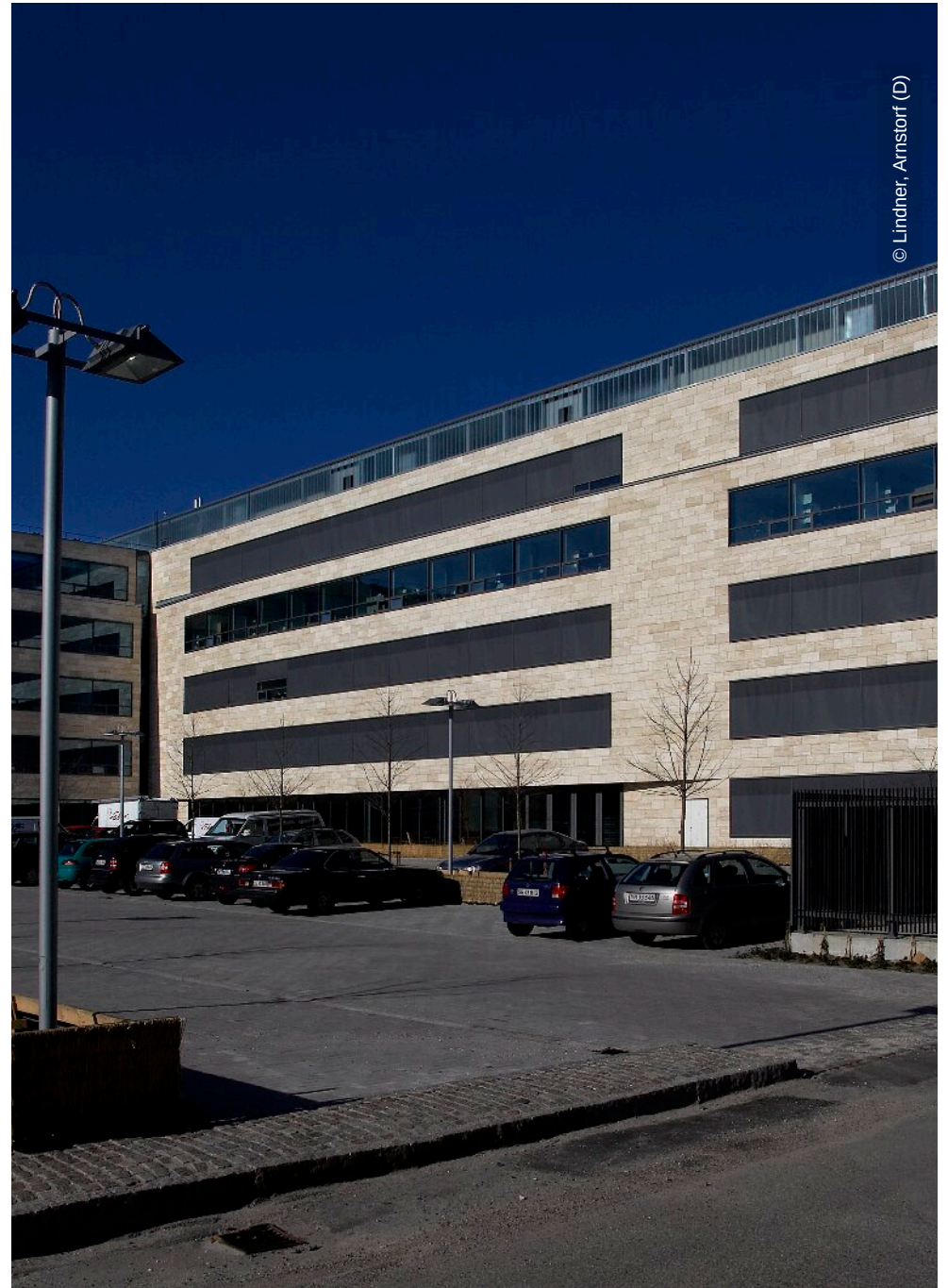

© Lindner, Arnstorf (D)



© Lindner, Arnstorf (D)

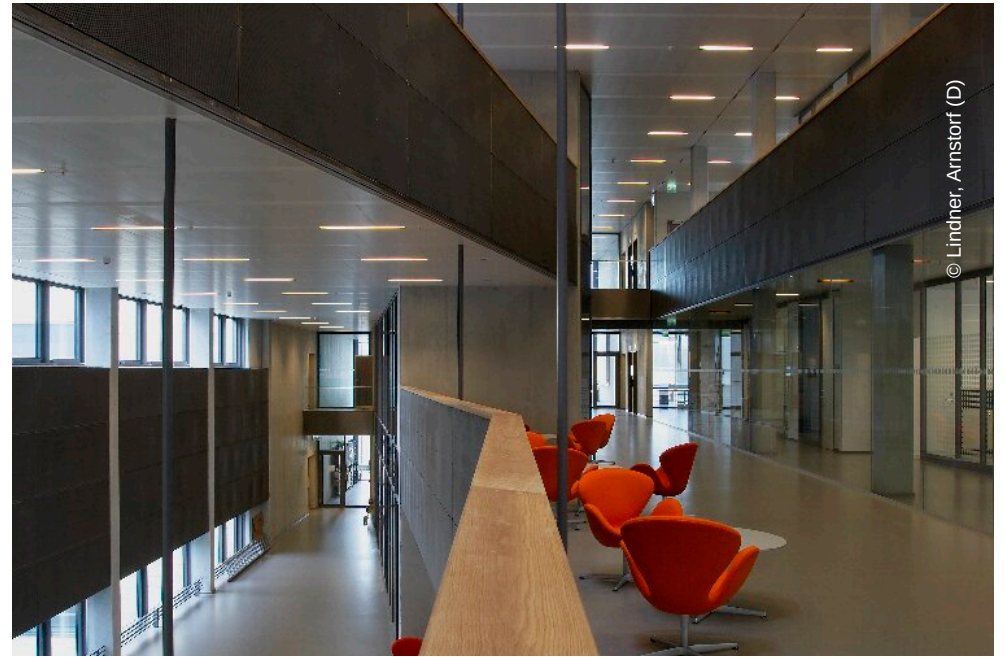

© Lindner, Arnstorf (D)



© Søren Weile, Kopenhagen