

easyCredit Headquarters

Nuremberg, Germany





Project Description

In December 2014, Teambank AG has moved into its new headquarters in Nuremberg. With a usable area of 15,000 sqm, the building offers enough space for over 700 employees of the instalment loan specialist. Its design, however, is quite unusual for a bank: innovative, activity-based workplaces in attractive open-space environments. This modern working environment was drafted by Swiss specialist Evolution Design AG. Apart from the functional aspects of the new headquarters, its open and transparent structure also symbolises the brand values of easyCredit. \r\nDuring the interior fit-out of the new construction, Lindner was contracted with the installation of heating and cooling ceiling systems. The open-space office areas have been fitted with Lindner metal hook-on ceilings, some of which featuring heating and cooling technology. On-site circumstances such as a large number of installations in the ceiling void or very shallow suspension heights sometimes required the construction of split-level ceilings. The central meeting areas have been fitted with a plasterboard ceiling that is not only appealing, but also highly functional: integrated Heating and Cooling Technologies are used to regulate the temperature in these large areas. The scattered perforation in the ceiling's surface improves acoustics and appearance while it also facilitated their installation.

General

Building Type	Office buildings
Completion	2014 - 2013
Client	Sontowski & Partner Group
Architect	GP Wirth Architekten

Completed Works

- **Ceilings**
 - Heated and Chilled Post Cap Ceilings
 - Heated and Chilled Hook-On Ceilings
 - Heated and Chilled Plasterboard Ceilings
 - Plafotherm® GK HEKDA®



© www.Lindner-Group.com



© www.Lindner-Group.com

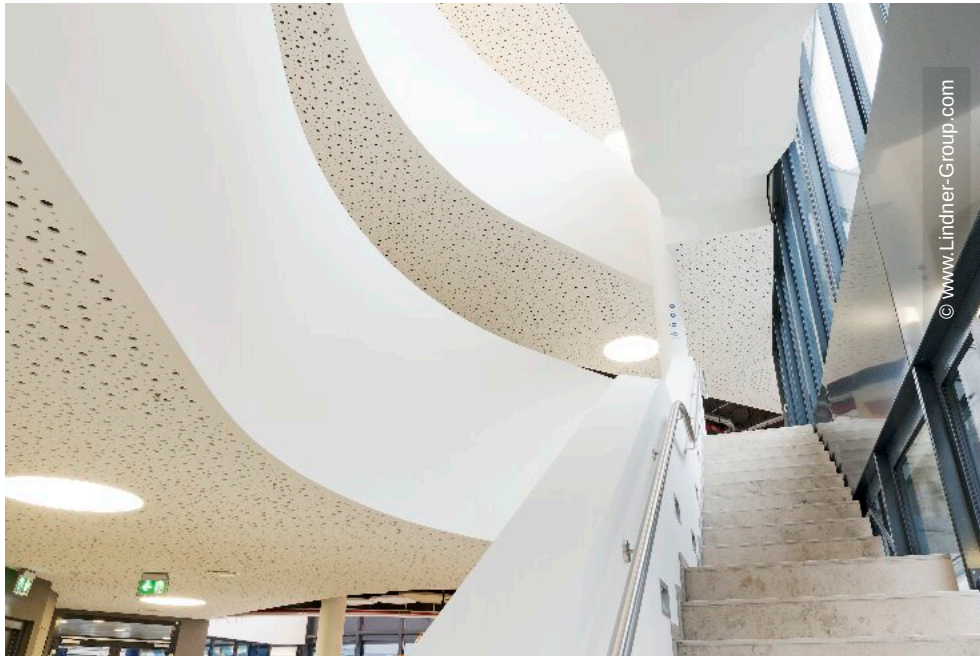

© www.Lindner-Group.com



© www.Lindner-Group.com



© TeamBank AG/easyCredit