

arabeska

Munich, Germany

 **Lindner**



Project Description

With the completion of the new construction 'arabeska' in 2015, Munich's HVB-Tower acquired an unusual new neighbour. Following a construction period of three years, this multi-purpose building now features flowing shapes, light-flooded liberality and ornamentations of Arabian architecture, which lend the building its name. The facility consists of a main building and an adjoining structure. The ground floor of the main building is composed of a large-scale central atrium surrounded by event and conference areas and a restaurant. The upper floors are designed for housing office spaces. As to the adjoining structure, a training and conference center of a household appliances manufacturer has been established in these premises. As a part of the new construction, Lindner was contracted with the production and installation of hollow and raised floor systems. Large areas of the building have been gentrified in this way. The event areas and the restaurant of the main building's ground floor have been fitted with parquet-coated FLOOR and more® hollow floors, while the office areas have been mainly fitted with NORTEC raised floors and carpet coating. Furthermore, CAVOPEX comfort hollow floors with integrated heating technology are used to control the temperature in the interior passageway spanning over the inner courtyard. The adjoining structure's appearance differs in regard of the flooring systems. There, large-format (1.2 by 1.2 m) ceramic tiles have been laid on the whole floor area of the structure while applying the innovative DryMode laying method. This procedure requires neither primer nor adhesives, which saved a large amount of time in comparison to other tiling methods. NORTEC raised floors have been used as a substructure for the tiling in this project.

General

Building Type	Business premises, Multipurpose buildings, Office buildings, Concert Halls
Company Division	Lindner SE Floors

Completion	2015
Client	Bayerische Versorgungskammer
Architect	Sellack Architekten + Ingenieure

Completed Works

- **Floors**
 - Calcium sulphate panels
 - NORTEC
 - FLOOR and more®
 - Nasshohlboden
 - CAVOPEX comfort

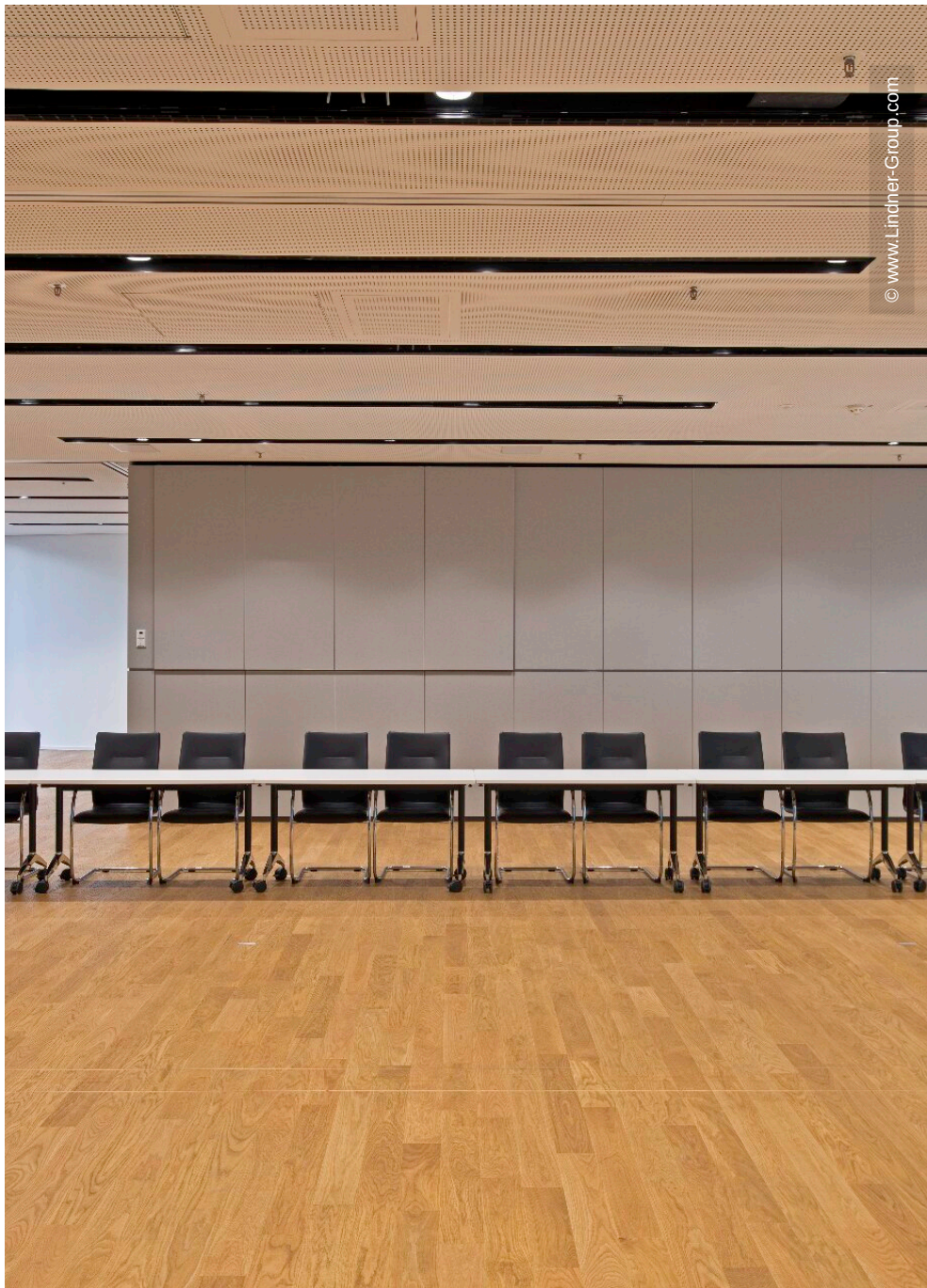



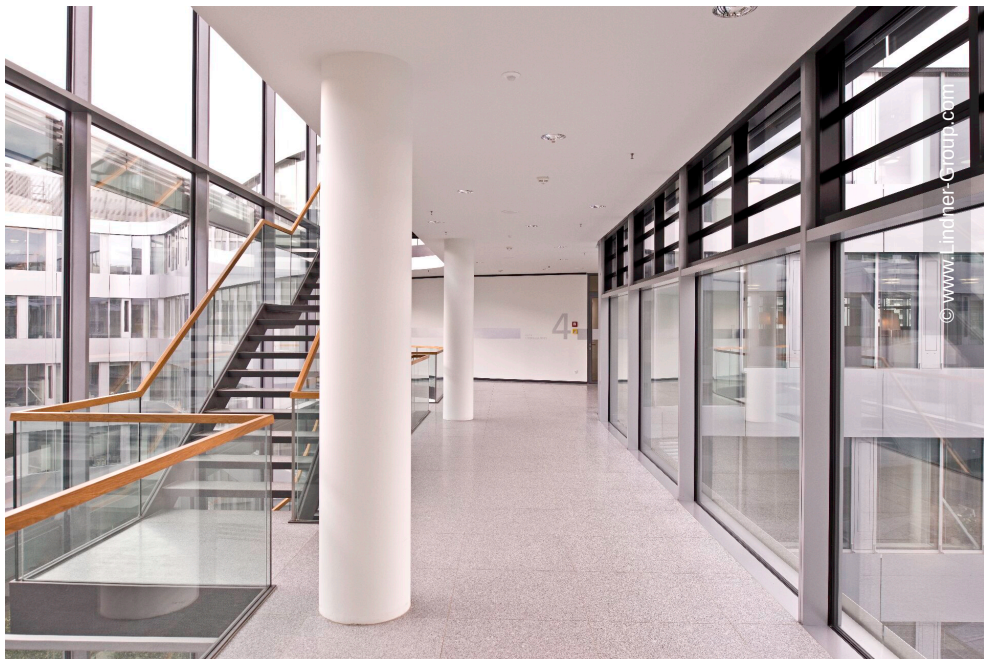

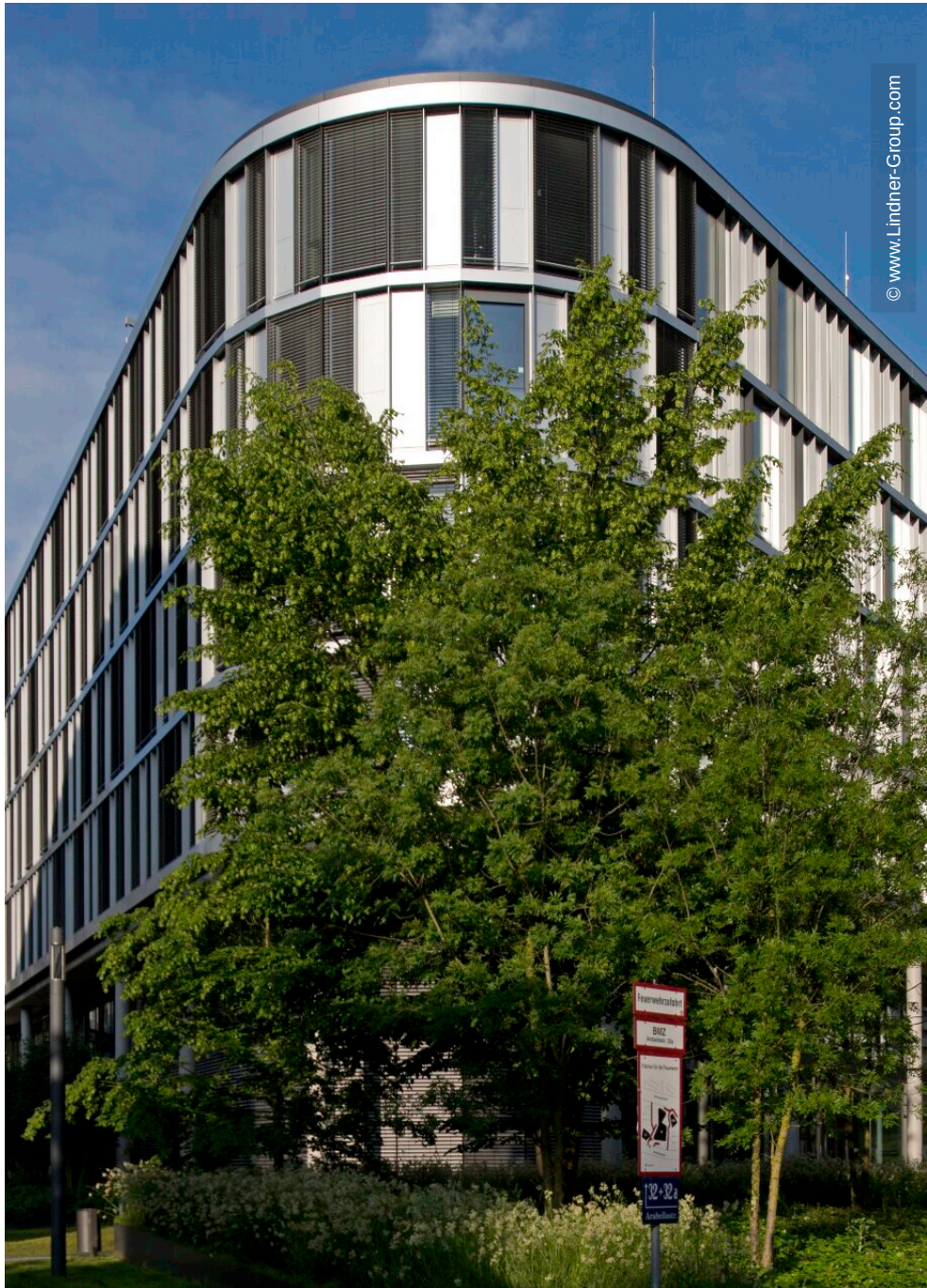

© www.Lindner-Group.com



© www.Lindner-Group.com

