

# MAM 7051

Grosshöflein, Austria

 **Lindner**



© paul ott fotografiert

# Project Description

Großhöflein: The new research and development center of the well-known Austrian baby products brand MAM. Not only modern, but also sustainable was one of the main considerations for the realization of this building. With its numerous tested and certified environmentally friendly products, Lindner was able to take on the execution of various trades in the area of interior fit-out. After the groundbreaking ceremony in April 2020, the geothermal building has been ready for occupancy since November 2021. Lindner realized the raised floor system, the plasterboard walls, plasterboard ceilings and the baffle ceilings.

- **Ceilings**
  - Baffle Ceilings
    - LMD-L 601
  - Plasterboard ceiling systems
  - Plasterboard partition systems

## General

<b>Building Type</b>	Office buildings
<b>Company Division</b>	Lindner GmbH
<b>Completion</b>	2020 - 2021
<b>Client</b>	Porr Bau GmbH

## Completed Works

- **Floors**
  - Calcium sulphate panels
    - NORTEC 500 sqm
    - NORTEC power 10 sqm
  - Chipboard panels
    - LIGNA 1700 sqm



© paul ott fotografiert

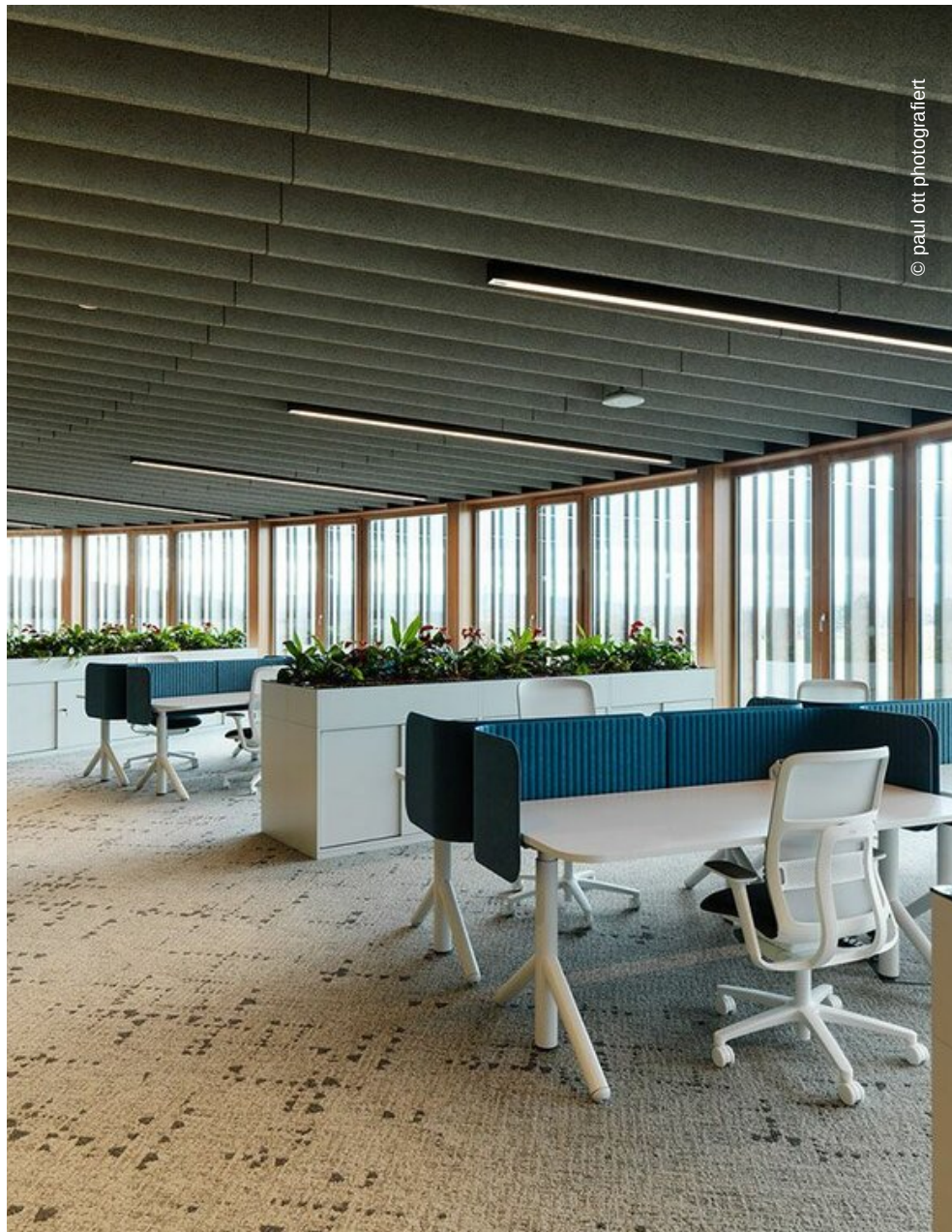

© paul ott fotografiert

