

# Lawrence Public Library

Lawrence, United States





# Project Description

As part of the renovation of the public library in Lawrence, the focus was on creating new spaces. Rather than building an extension on one side of the building, which would have impacted the surrounding neighbourhood, or adding additional floors, which would have overstressed the foundation designed for a single-storey structure, the decision was made to wrap the expansion all around the existing structure.

A key element of the interior design was the installation of Lindner's LMD-L 601 metal baffle ceiling, which features a linear structure and visible substructure with a suspension rail grid. Various spacing options are available, allowing for flexible design. The space above the ceiling can be utilised for ventilation systems, and the open areas within the ceiling provide room for various installations, such as lighting, sprinkler systems, or the hanging of signs. The perforated baffles, fitted with special inlays, are highly effective for sound absorption. Additionally, similar ceiling systems can be supplied with heating and cooling technology, ensuring added comfort.

## General

<b>Building Type</b>	Library Rooms
<b>Company Division</b>	Lindner USA Inc.
<b>Completion</b>	2014
<b>Client</b>	Drewco Inc.

Architect

Gould Evans

## Completed Works

- **Ceilings**  
Baffle Ceilings  
LMD-L 601





© Tim Griffith

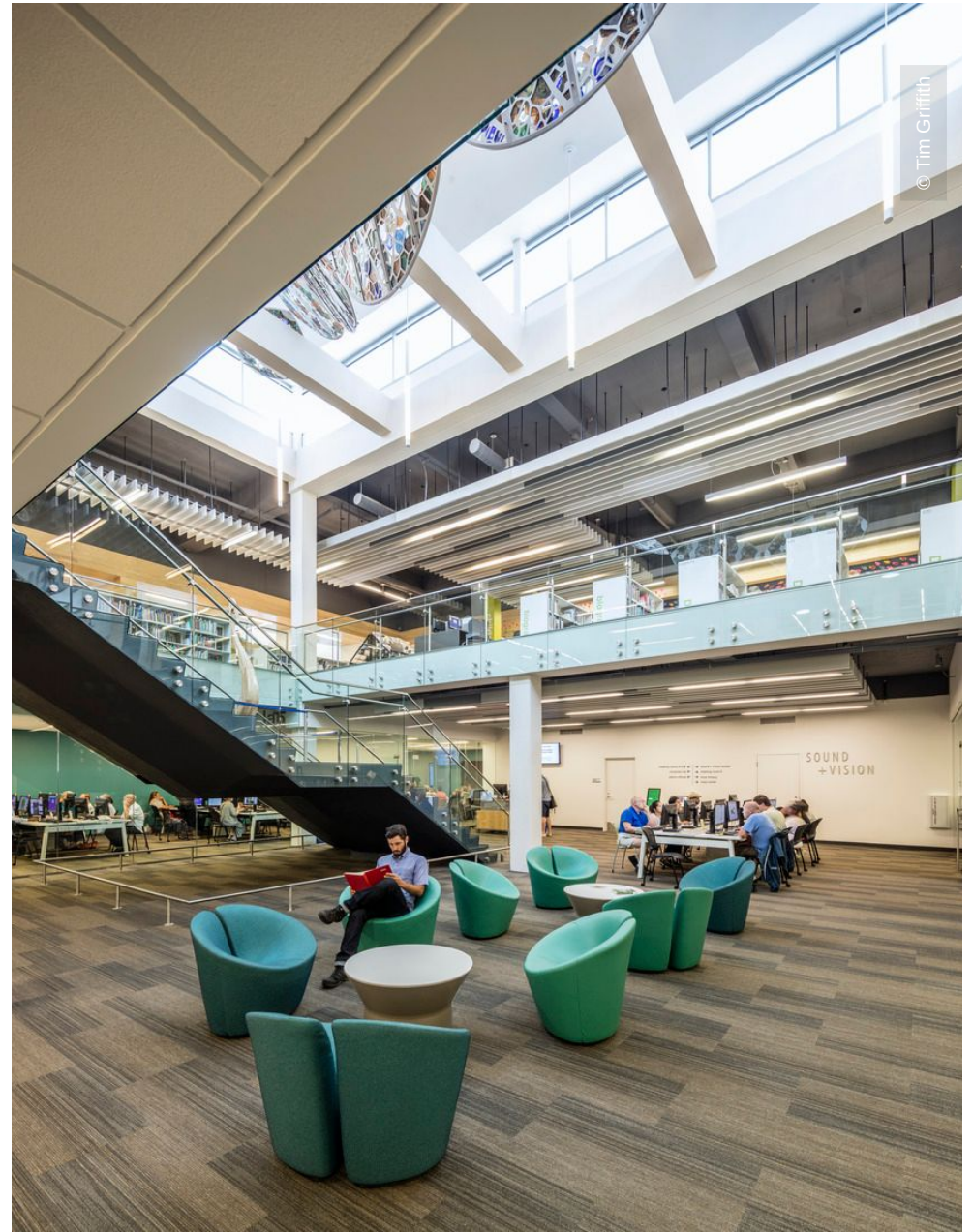

© Tim Griffith

